



Oil and Fuel Filter Vessels

Model 511 and 512

The Model 511 and 512 oil and fuel filtration filter vessels are designed to offer an operator friendly solution for industrial oil and fuel filtration applications. The 511 and 512 vessels are rugged, heavy-duty, carbon steel constructed, and utilize an unique "T" top handle for filter element replacement. The Model 511 and 512 vessels are designed to provide oil filtration or fuel filtration for a wide range of industrial applications. The Model 511 and 512 vessels can be used in the following locations:

- Power Plants – turbine oil, gear oil, and diesel fuel
- Pulp & Paper Mills – paper machine oil and hydraulic oil
- Steel and Aluminum Mills – rolling mill lube system oil, gear oil, hydraulic oil, and cutting oil
- Marine – engine oil and diesel fuel
- Mining – crusher lube system oil and diesel fuel
- Refinery and Chemical Plants – compressor and turbine oil
- Fueling Terminals – diesel fuel
- General Industry – lube oil, hydraulic oil, transformer oil, and diesel fuel



BENEFITS

- o **Operator Friendly:** The "T" top handle makes the element change-out procedure quick and simple. No tools are required. Element change-out is performed in two minutes.
- o **Positive Element Sealing:** As the operator is closing the vessel lid by twisting the "T" top handle, the "T" top spring compresses against the element sealing plate, which provides a secure seal against fluid bypass.

o **Reduced Fluid Resistance:** Pressure drop through the 511 or 512 vessel is minimized, creating longer element life, and less strain on the pumping assembly.

Diesel Fuel # 2:

Model 511 with KM6018-2 at 50 gpm = less than 3 psid

Model 512 with KM6036-2 at 100 gpm = less than 4 psid

o **Equipment Protection:** The Model 511 and 512 vessels can be used in oil or diesel fuel applications

- > Oil - Protects components in your oil system
- > Diesel Fuel - Guards against contamination entering your diesel engine.

FOOTNOTES

- (1) As measured with inline automatic particle monitor calibrated to ISO 11171 and influent no greater than ISO 20/19/16
 (2) Required for element changes.

DS041312511512

SPECIFICATIONS & DETAILS

| | | | | | | | | | | | | | | | |
|---------------------------------------|---|--------------------------|------------------------|-------------------------|--------------------------|--------------------------|--------------------------|--------------------------|-------------------------|--|-------------------------|--------------------------|-------------------------|------------------------------------|--------------------------|
| Pressure and Temp. | 500 PSIG (35 BAR) at 250 F (121 C) (maximum allowable operating pressure) | | | | | | | | | | | | | | |
| Environmental Parameters | Minimum Temperature: 0 F (-17 C) Maximum Temperature: 120 F (49 C) | | | | | | | | | | | | | | |
| Materials of Construction | Metals: Ductile Iron, Carbon Steel and Bronze Elastomers: Buna-N Exterior Coating: Epoxy (weather and corrosion resistant) Interior Coating: Rust Preventative (Epoxy - option) | | | | | | | | | | | | | | |
| Inlet/Outlet Connections | Standard: 2 inch NPT Optional: 2 inch or 2.5 inch SAE 4-Bolt Flange | | | | | | | | | | | | | | |
| Fluid Compatibility | Mineral Base Oils and Fuels (diesel # 1 and #2) | | | | | | | | | | | | | | |
| Weight | 511: 88 lbs (40 kgs) / 512: 123 lbs (56 kgs) | | | | | | | | | | | | | | |
| Dimensions | 511: 10 inches L x 10 inches W x 29 inches H (254 mm L x 254 mm W x 740 mm H) 512: 10 inches L x 10 inches W x 47 inches H (254 mm L x 254 mm W x 1200 mm H) | | | | | | | | | | | | | | |
| Element Selection Model 511 | General Purpose Oil or Fuel Filtration: KF6018-05 / KF6018-5 / KF6018-10 / KF6018-25 Critical Purpose Oil or Fuel Filtration: KM6018-02 / KM6018-05 / KM6018-2 / KM6018-3 / KM6018-8 / KM6018-15 Water Absorption from Oils or Fuel: KQD6018-6NS (max. flow for KQD6018-6NS: 15 gpm with ISO 32 oil) | | | | | | | | | | | | | | |
| Element Selection Model 512 | General Purpose Oil or Fuel Filtration: KF6036-05 / KF6036-5 / KF6036-10 Critical Purpose Oil or Fuel Filtration: KM6036-02 / KM6036-05 / KM6036-2 / KM6036-3 / KM6036-8 / KM6036-15 Water Absorption from Oils or Fuel: KQD6036-6NS (max. flow for KQD6036-6NS: 30 gpm with ISO 32 oil) | | | | | | | | | | | | | | |
| Performance ⁽¹⁾ | ISO Cleanliness Codes: <table border="0" style="width: 100%;"> <tr> <td>KF60XX-05 - ISO 15/13/11</td> <td>ISO Cleanliness Codes:</td> </tr> <tr> <td>KF60XX-5 - ISO 18/16/13</td> <td>KM60XX-02 - ISO 15/13/10</td> </tr> <tr> <td>KF60XX-10 - ISO 19/17/14</td> <td>KM60XX-05 - ISO 15/13/11</td> </tr> <tr> <td>KF6018-25 - ISO 19/18/15</td> <td>KM60XX-2 - ISO 16/14/12</td> </tr> <tr> <td></td> <td>KM60XX-3 - ISO 16/15/13</td> </tr> <tr> <td>KQD60XX-5 - ISO 18/16/13</td> <td>KM60XX-8 - ISO 18/17/14</td> </tr> <tr> <td>Water Removal to less than 200 ppm</td> <td>KM60XX-15 - ISO 19/18/15</td> </tr> </table> | KF60XX-05 - ISO 15/13/11 | ISO Cleanliness Codes: | KF60XX-5 - ISO 18/16/13 | KM60XX-02 - ISO 15/13/10 | KF60XX-10 - ISO 19/17/14 | KM60XX-05 - ISO 15/13/11 | KF6018-25 - ISO 19/18/15 | KM60XX-2 - ISO 16/14/12 | | KM60XX-3 - ISO 16/15/13 | KQD60XX-5 - ISO 18/16/13 | KM60XX-8 - ISO 18/17/14 | Water Removal to less than 200 ppm | KM60XX-15 - ISO 19/18/15 |
| KF60XX-05 - ISO 15/13/11 | ISO Cleanliness Codes: | | | | | | | | | | | | | | |
| KF60XX-5 - ISO 18/16/13 | KM60XX-02 - ISO 15/13/10 | | | | | | | | | | | | | | |
| KF60XX-10 - ISO 19/17/14 | KM60XX-05 - ISO 15/13/11 | | | | | | | | | | | | | | |
| KF6018-25 - ISO 19/18/15 | KM60XX-2 - ISO 16/14/12 | | | | | | | | | | | | | | |
| | KM60XX-3 - ISO 16/15/13 | | | | | | | | | | | | | | |
| KQD60XX-5 - ISO 18/16/13 | KM60XX-8 - ISO 18/17/14 | | | | | | | | | | | | | | |
| Water Removal to less than 200 ppm | KM60XX-15 - ISO 19/18/15 | | | | | | | | | | | | | | |
| Vessel Lid Seal ⁽²⁾ | 54M99 (Model 511 and 512) | | | | | | | | | | | | | | |

OPTIONS

| Description | Description | Description |
|--------------------------------------|---|-------------|
| Port Size (2 or 2.5 inch SAE flange) | Differential Pressure Device Inlet/Outlet Gauges or DP Gauge (switch optional) | Viton Seals |
| By-Pass Valve (15, 25, or 40 psid) | | |



PRESSURE DROP CURVES

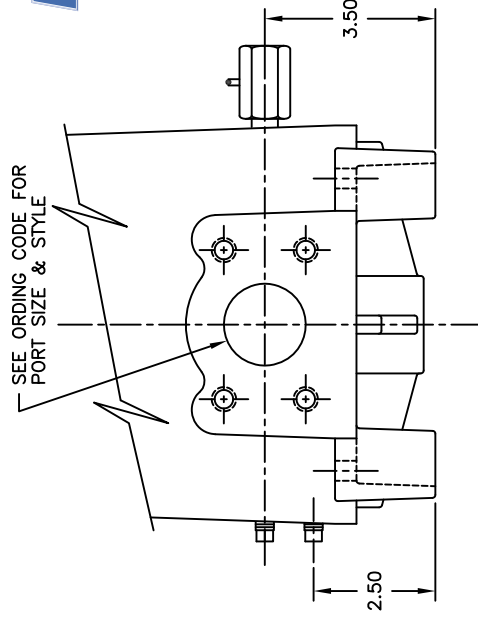
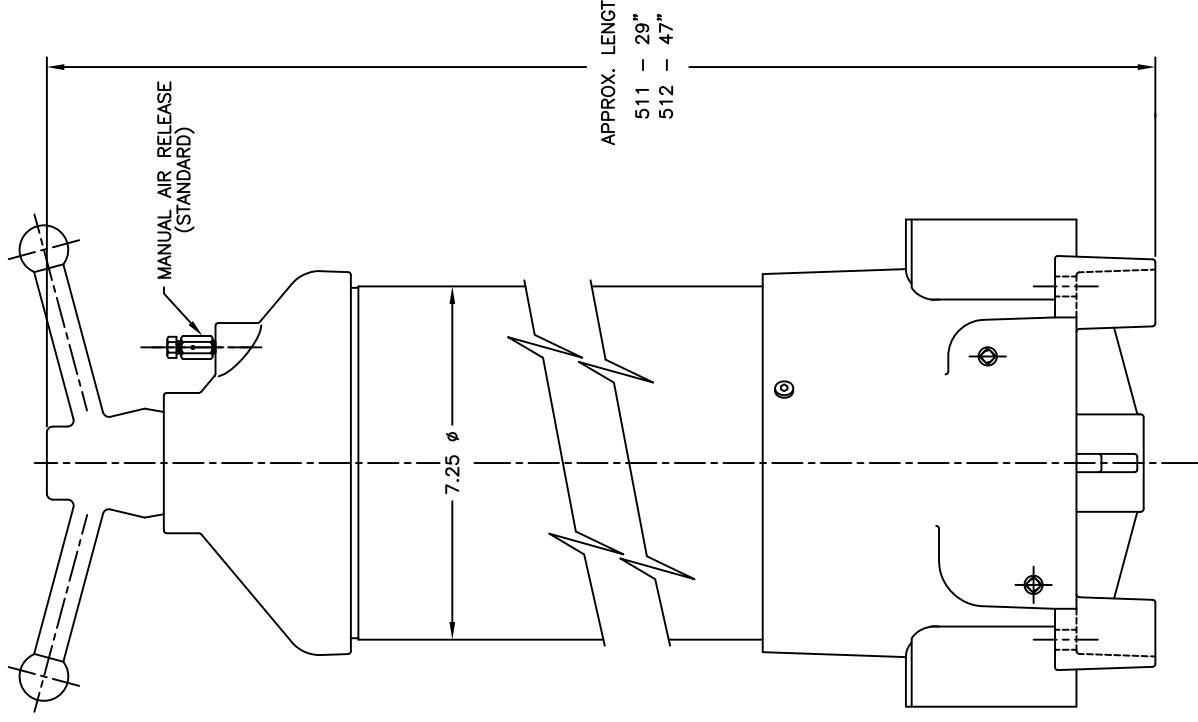
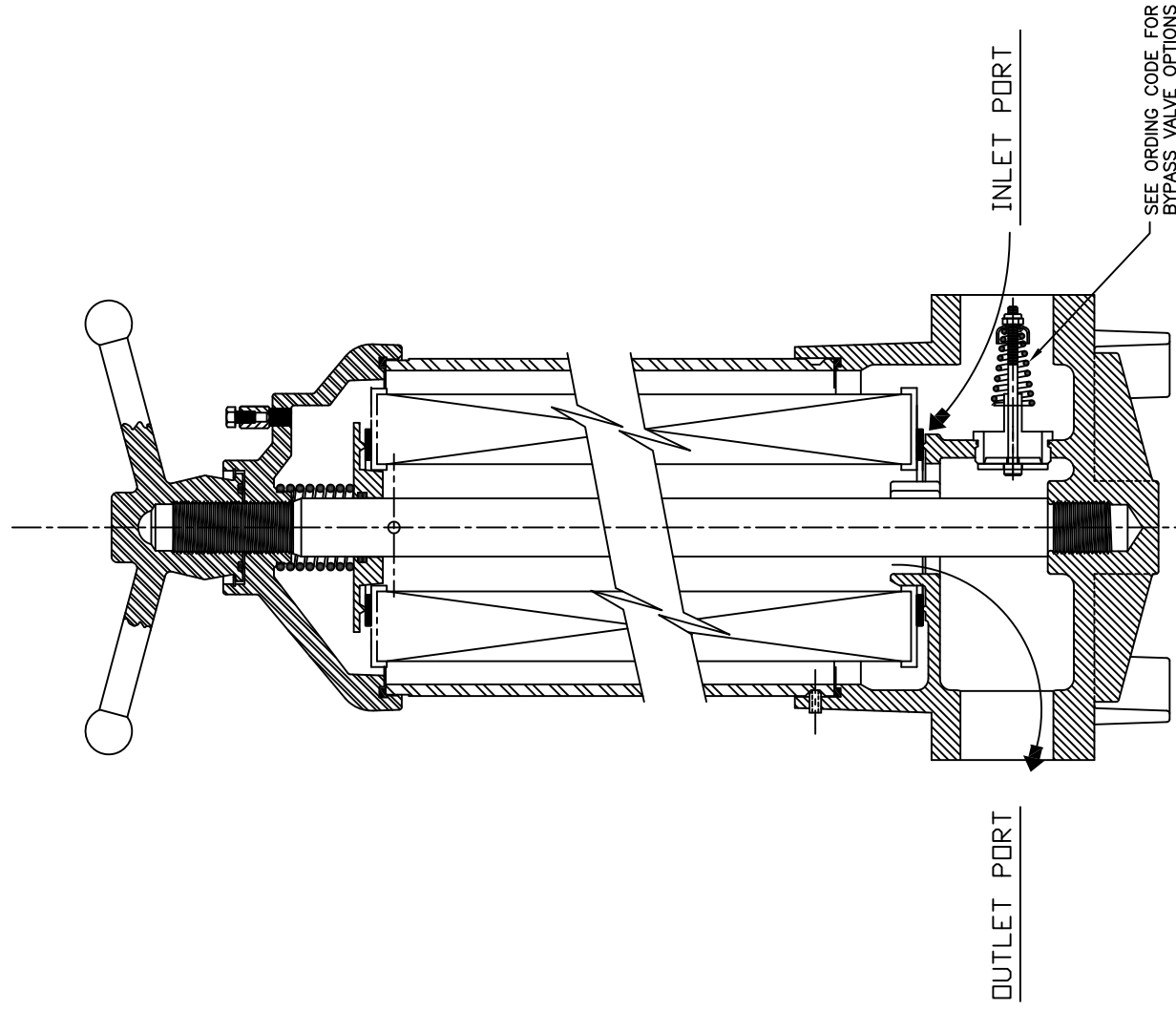
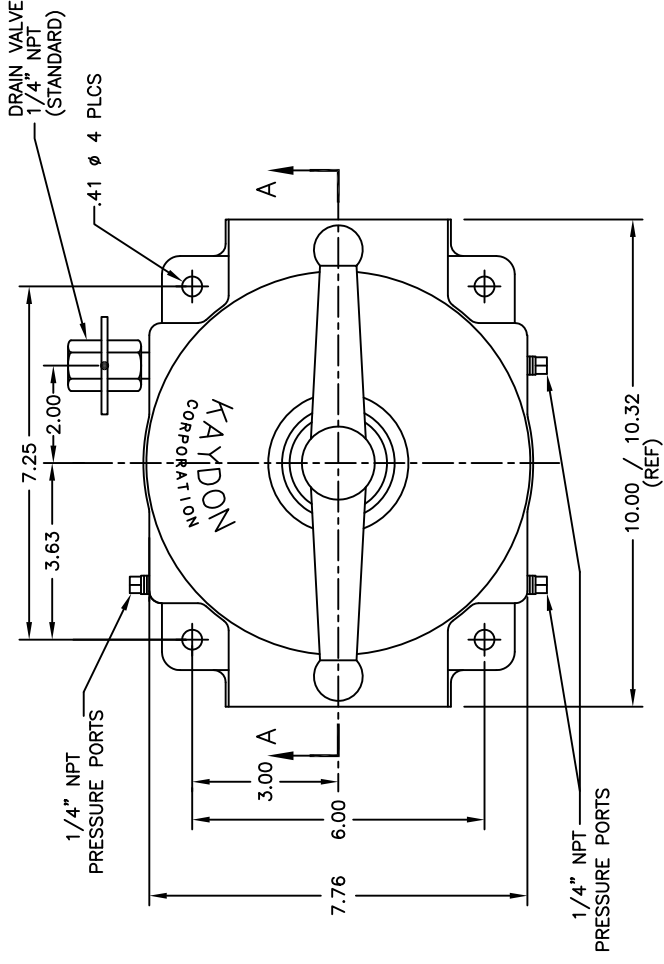
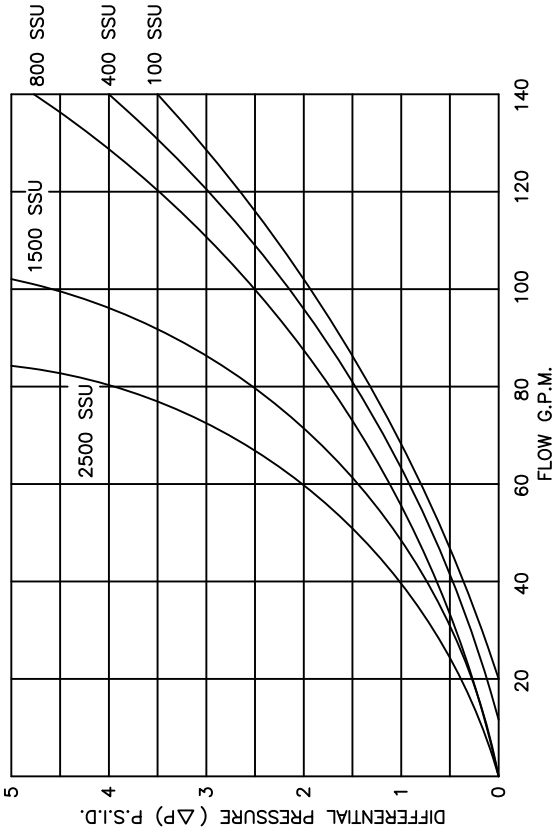

| NUMBER OF 18 INCH ELEMENTS | |
|----------------------------|----------|
| SYMBOL | QUANTITY |
| 1 | 1 |
| 2 | 2 |
| SEE NOTE 7 | |

| PORT SIZE OPTION | |
|------------------|--------|
| SYMBOL | SIZE |
| 32 | 2" |
| 40 | 2-1/2" |

| GAUGE OPTION | |
|--------------|-------------------------|
| SYMBOL | DESCRIPTION |
| NP | NONE |
| GL | GAUGES (0-600 PSIG) |
| DPG | 0-35 PSID DELTA-P GAUGE |

| BYPASS VALVE OPTION | |
|---------------------|-------------|
| SYMBOL | DESCRIPTION |
| NB | NO BYPASS |
| 15 | 15 PSID |
| 25 | 25 PSID |
| 40 | 40 PSID |

| PORT STYLE OPTION | |
|-------------------|--|
| SYMBOL | PORT STYLE |
| F | SAE SPLIT FLG. PER J518 STD. PRESSURE SERIES PIPE-N.I.P.T. |
| P | PIPE-N.I.P.T. |

MODEL 51

• VALVE CRACKING PRESSURE
▼ 2" SIZE ONLY

NOTE :

- ALL CAST DUCTILE IRON AND CARBON STEEL CONSTRUCTION.
- MAXIMUM OPERATING PRESSURE : 500 PSI @ 250' F MAX. LEAK TEST, WITH 80 P.S.I.G (AIR)
- UNIT EQUIPPED WITH NITRILE (BUNA N) SEALS. * FLUOROELASTOMER SEALS AVAILABLE.
- FINISH, INTERIOR: RUST PREVENTATIVE FINISH, EXTERIOR: EPOXY (KAYDON BLUE)
- DUST CAPS INSTALLED IN ALL OPEN THROUGH HOLES.
- DRY WEIGHT (APPROX.) (NO ELEMENTS IN HOUSING): 88 LBS. (511) 123 LBS. (512)
- MODEL 512 ACCEPTS TWO (2) 6018 ELEMENTS (MUST USE CONNECTOR PLATE - PART NUMBER 54M32) OR ACCEPTS ONE (1) 6036 ELEMENT. CAN USE ANY KM, KF, OR KD STYLE KAYDON ELEMENT
- SAE O-RING GROOVE MUST BE IN COMPANION FLANGE FOR PORT STYLE "F" OPTION

| REV | DATE | BY | CHKD | DESCRIPTION |
|-----|----------|-----|------|-------------|
| 1 | 04/17/96 | ... | ... | ... |

| | |
|--------------------------|--|
| UNITS FOR ALL DIMENSIONS | INCH |
| DIMENSIONS ARE IN INCH | |
| MANUFACTURER | KAYDON FILTRATION |
| MODEL | MODEL 511/512 (NON-CODE) |
| ADDRESS | 1971 LARKEN INDUSTRIAL WAY WEST LARKEN, CA 92040 |
| PHONE | (619) 441-1111 |
| FAX | (619) 441-1117 |
| DATE | 05/01/96 |
| REV | 1 |

© COPYRIGHT 2008 KAYDON FILTRATION CORPORATION. ALL RIGHTS RESERVED. THIS DOCUMENT IS THE PROPERTY OF KAYDON FILTRATION CORPORATION AND IS TO BE USED ONLY FOR THE PURPOSES AND IN THE MANNER SPECIFIED HEREIN. ANY REPRODUCTION OR TRANSMISSION OF THIS DOCUMENT WITHOUT THE WRITTEN PERMISSION OF KAYDON FILTRATION CORPORATION IS STRICTLY PROHIBITED. KAYDON FILTRATION CORPORATION IS NOT RESPONSIBLE FOR ANY DAMAGE TO PERSONS OR PROPERTY CAUSED BY THE USE OF THIS DOCUMENT. KAYDON FILTRATION CORPORATION IS NOT RESPONSIBLE FOR ANY DAMAGE TO PERSONS OR PROPERTY CAUSED BY THE USE OF THIS DOCUMENT.